



## BD 50/70 R Classic \*KAP

For an area performance of up to 2,000 m<sup>2</sup> per hour: the battery powered BD 50/70 R Classic ride-on scrubber drier with disc brush. Batteries and charger must be ordered separately.



### 1 Easy operation

- Self-explanatory symbols and clear control panel.
- Brief familiarisation phases.

### 2 Disc brush engineering

- Robust construction style with integrated disc brush head.
- High area performance thanks to large working width.

### 3 Compact, slim design

- Extremely manoeuvrable machine.
- Clear view of surfaces to be cleaned.

### 4 Optional accessories: pre-sweep mop

- Picks up dry dirt, thus supporting the cleaning process.
- Helps prevent blockage of the suction channel.



## BD 50/70 R Classic \*KAP

- Compact slim design and extremely manoeuvrable
- Extremely easy and intuitive operation
- Disc brush engineering (one disc)

### Technical data

<b>Order no.</b>	1.161-076.0	
<b>EAN code</b>	4054278554082	
<b>Working width of brushes</b>	mm	510
<b>Working width, vacuuming</b>	mm	900
<b>Tank of fresh/dirty water</b>	l	70 / 70
<b>Theoretical area performance</b>	m <sup>2</sup> /h	2805
<b>Brush rotational speed</b>	rpm	155
<b>Brush contact pressure</b>	kg	19,5
<b>Battery run time</b>	h	max. 3
<b>Dimensions (L x W x H)</b>	mm	1310 × 590 × 1060

### Equipment

<b>Disc brush</b>	■
<b>Powerful traction drive</b>	■
<b>Automatic water stop</b>	■
<b>Tin</b>	-
<b>Solenoid valve</b>	■
<b>Squeegee, v-shape</b>	■
<b>2-tank system</b>	■

■ Included in the scope of supply.

# BD 50/70 R CLASSIC \*KAP 1.161-076.0



		Order no.	Hardness grade	Diameter	Colour	Quantity	Price	Description	
<b>Disc brushes</b>									
Disc brush	1	4.905-026.0	medium	510 mm	red	1 piece(s)		Red standard disc brush for regular maintenance cleaning.	<input checked="" type="checkbox"/>
Disc brush complete white D51	2	4.905-028.0	very soft	510 mm	White	1 piece(s)		White, soft disc brush for the gentle cleaning of sensitive floor coverings.	<input type="checkbox"/>
Disc brush	3	4.905-027.0	soft	510 mm	natural	1 piece(s)		Natural-coloured, soft disc brush for cleaning and polishing textured floor coverings.	<input type="checkbox"/>
Disc brush complete black D51	4	4.905-029.0	hard	510 mm	black	1 piece(s)		Black, very abrasive disc brush for the deep cleaning of hard-wearing floor coverings with very sticky dirt.	<input type="checkbox"/>

■ Included in the scope of supply. □ Available accessories.

# BD 50/70 R CLASSIC \*KAP 1.161-076.0

**KÄRCHER**

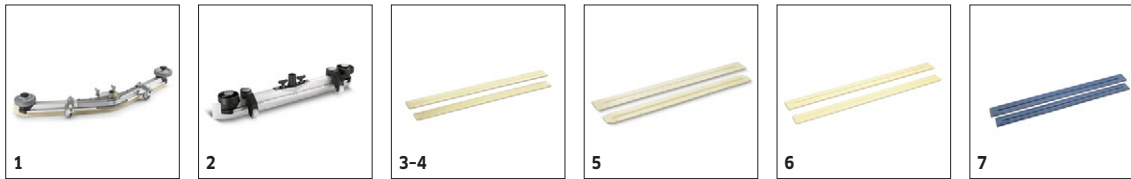

		Order no.	Length	Colour	Quantity	Price	Description	
<b>Squeegees</b>								
Squeegee	1	4.777-079.0	900 mm	transparent	1 piece(s)		900 mm long, V-shaped squeegee with suction lips made from wear- and oil-resistant polyurethane with a long lifetime and for all floors. With spirit level for precise adjustment.	■
	2	4.777-401.0	850 mm	transparent	1 piece(s)		Straight, with support rollers. Squeegee blades of oil-resistant, transparent polyurethane.	□
<b>Squeegee blades</b>								
Squeegee blades for V-squeegee	3	6.273-023.0	1010 mm	transparent	2 -part		Suction lip set, fluted and developed for V-shaped squeegees with length of 900 mm. The suction lips are made of wear- and oil-resistant polyurethane and are suitable for all floors.	□
Rubber lip set oil resistant BR-BD530,55	4	6.273-207.0	890 mm	transparent	2 -part		Squeegee blade kit includes front and rear squeegee blades, 890 mm. Grooved squeegee blades of hard-wearing, oil-resistant, transparent polyurethane. For all standard floors.	□
Squeegee blades	5	6.273-229.0	890 mm	transparent	2 -part		Squeegee blade kit includes front and rear squeegee blades, 890 mm. Slotted squeegee blades of hard-wearing, oil-resistant, transparent polyurethane. For sensitive floors.	□
	6	6.273-290.0	890 mm	transparent	2 -part		Suction lip set, consisting of front and rear suction lip. 890 mm long. In an enclosed design made from wear-resistant, oil-resistant and transparent polyurethane. For textured floors.	□
Rubber lip set standard	7	6.273-213.0	890 mm	blue	2 -part		Squeegee blade kit includes front and rear squeegee blades, 890 mm. Soft natural rubber grooved squeegee blades. For all standard floors.	□

■ Included in the scope of supply. □ Available accessories.

# BD 50/70 R CLASSIC \*KAP 1.161-076.0

**KÄRCHER**



		Order no.	Hardness grade	Diameter	Colour	Quantity	Price	Description	
<b>Microfibre pad</b>									
Microfibre pad	1	6.371-271.0		508 mm	White	5 piece(s)		Microfibre disc pad for the reliable and gentle removal of grey haze. Ideal for fine stoneware tiles.	<input type="checkbox"/>
<b>Pads</b>									
Pad	2	6.369-468.0	soft	508 mm	beige	5 piece(s)		Beige-coloured disc pad with fine abrasive for cleaning and polishing.	<input type="checkbox"/>
	3	6.369-079.0	medium-soft	508 mm	red	5 piece(s)		Red, standard disc pad for regular maintenance cleaning.	<input type="checkbox"/>
	4	6.369-078.0	medium-hard	508 mm	green	5 piece(s)		Green, abrasive roller pad for deep cleaning, as well as the removal of sticky dirt.	<input type="checkbox"/>
	5	6.369-077.0	hard	508 mm	black	5 piece(s)		Black, very abrasive disc pad for the deep cleaning of hard-wearing floor coverings with very sticky dirt.	<input type="checkbox"/>
	6	2.639-258.0	hard	508 mm	brown	2 piece(s)		Very abrasive disc pad for chemical-free care film and decoating.	<input type="checkbox"/>
	7	6.371-146.0	soft	500 mm	beige / natural	5 piece(s)		Beige-coloured disc pad with fine abrasive for cleaning and polishing.	<input type="checkbox"/>
<b>Pad drive boards</b>									
Pad drive board STRONG	8	4.762-593.0		479 mm		1 piece(s)		Required for use of melamine pads, but can also be used for normal pads. Pad drive board with lots of extra hooks for holding pads. Extra-strong hold of the pad at the pad drive board of the cleaning head D 51.	<input type="checkbox"/>
Pad drive board	9	4.762-534.0		479 mm		1 piece(s)		For cleaning with pads. With quick-change coupling and Centerlock.	<input type="checkbox"/>
<b>Diamond pad</b>									
Diamond pad	10	6.371-260.0	coarse	508 mm	White	5 piece(s)		White, coarse diamond disc pad for hard floor coverings. Removes minor scratches and creates a clean, even matt base for further treatment with yellow diamond disc pad.	<input type="checkbox"/>
	11	6.371-261.0	medium	508 mm	yellow	5 piece(s)		Yellow, diamond disc pad for treating and maintaining hard floor coverings. For a silky matt surface which can then be polished with the green diamond disc pad.	<input type="checkbox"/>
	12	6.371-240.0	fine	508 mm	green	5 piece(s)		Green, fine diamond disc pad for polishing polishable floor coverings. Creates high-gloss surfaces and can also be used for crystallisation.	<input type="checkbox"/>
<b>Melamine pads</b>									
Melamine pad	13	6.371-025.0		508 mm	Grey/white	2 piece(s)		White melamine disc pad for intermediate and deep cleaning of microporous surfaces, as well as fine stone and other hard floor coverings. Can also be used for removing grey haze.	<input type="checkbox"/>

■ Included in the scope of supply. □ Available accessories.

# BD 50/70 R CLASSIC \*KAP 1.161-076.0

**KÄRCHER**

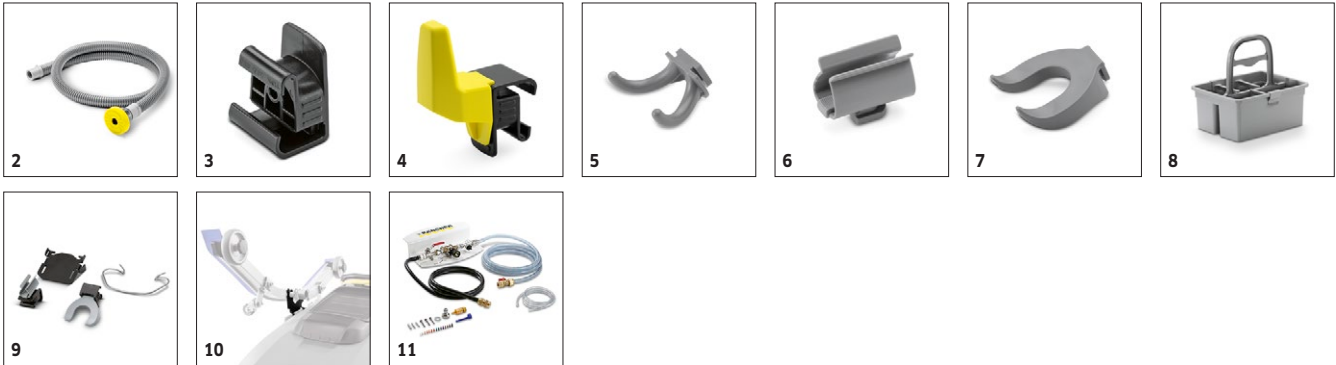

		Order no.	Length	Colour	Quantity	Price	Description	
<b>Miscellaneous</b>								
Add-on kit ecolzero	1	5.388-133.0			1 piece(s)		With ecolzero for climate-neutral cleaning: as compensation for the CO2 which is produced by using the machine, we support climate protection projects worldwide.	<input type="checkbox"/>
Filling hose	2	6.680-124.0	1.5 m		1 piece(s)		1,500-mm filling hose for easy device filling from a water tap. With universal tapered fitting for all standard taps.	<input type="checkbox"/>
<b>Home Base accessories</b>								
Home Base adapter	3	5.035-488.0			1 piece(s)		Fastener for various hooks and clips on the machine.	<input type="checkbox"/>
Universal hook kit	4	4.070-075.0			1 piece(s)		Hook and adaptor kit for attachment to the Home Base rail scrubber drier by Kärcher. Ideal for space-saving storage of hoses (for example, spray suction attachment kit) on the machine.	<input type="checkbox"/>
Double hook	5	6.980-077.0			1 piece(s)		Double hook for attaching rubbish bags, etc. to the machine. Only for use with the Homebase adapter 5.035-488.0.	<input type="checkbox"/>
Holder handhold grey	6	6.980-078.0		grey	1 piece(s)		Mop clip for attaching a mop to the machine. Only for use with the Homebase adapter 5.035-488.0.	<input type="checkbox"/>
Bottle holder	7	6.980-080.0		grey	1 piece(s)		Suitable for transporting spray bottles - only in conjunction with Home Base adapter 5.035-488.0.	<input type="checkbox"/>
Home Base Box Kit	8	4.035-406.0			1 piece(s)		The Box kit provides enough space for three cleaning agent bottles along with cloths, scrapers, spare rubbish bags, gloves, etc.	<input type="checkbox"/>
Home Base Kit mop holder	9	4.039-271.0			1 piece(s)		Mop holder allows you to carry a mop on the machine. Easy attachment, convenient use.	<input type="checkbox"/>
Holder for squeegee	10	9.753-088.0			1 piece(s)		Holder for squeegee: The steel holder is attached to the Home Base rail of the scrubber drier and allows the safe storage and transportation of the squeegee.	<input type="checkbox"/>
<b>Dosing aids</b>								
DS 3 Cleaning Agent Dosing Station	11	2.641-811.0			1 piece(s)		After connecting to a tap, cleaning agent can be filled into the fresh water tank and diluted as required. Can also be used with the filling system attachment kit. Includes back-flow preventer (DIN EN 1717).	<input type="checkbox"/>

■ Included in the scope of supply. □ Available accessories.

# BD 50/70 R CLASSIC \*KAP

## 1.161-076.0

**KÄRCHER**

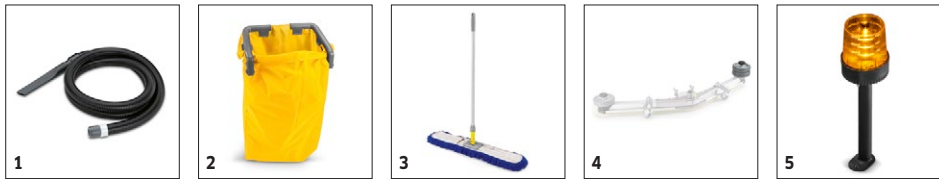

		Order no.	Length	Diameter	Quantity	Price	Description	
<b>Other attachment kits</b>								
Suction hose accessories	1	4.444-015.0	3.25 m		1 piece(s)		For vacuuming water out of corners or containers (e.g. freezers).	<input type="checkbox"/>
Bin liner holder attachment kit	2	4.039-269.0			1 piece(s)		Time-saving and useful accessory part: holder for convenient attachment of a bin liner or bin bag directly to the machine.	<input type="checkbox"/>
Attachment kit for the 60 cm pre-sweep mop	3	4.039-270.0			1 piece(s)		The pre-sweep mop can sweep up coarse dirt and it prevents coarse dirt from getting onto the brush head and into the squeegee.	<input type="checkbox"/>
Attachment kit stacked bumper roller squeegee	4	4.035-619.0			2 -part		Additional, non-marking bumper rollers for assembly at the ends of the squeegee. Effectively prevent the squeegee from hooking onto pallets or shelf feet.	<input type="checkbox"/>
<b>Lighting / revolving signal light mounting kit</b>								
Flashing beacon	5	4.039-267.0			1 piece(s)		Non-glare flashing beacon increases safety when working in dark buildings.	<input type="checkbox"/>

■ Included in the scope of supply. □ Available accessories.

# BD 50/70 R CLASSIC \*KAP 1.161-076.0



		Order no.	Quantity	Battery voltage	Battery capacity	Battery type	Price	Description	
<b>Batteries</b>									
Battery kit	1	2.815-100.0	2 -part	24 V	105 Ah	mainte-nance-free		Battery kit with 24 V voltage and 105 Ah (C5) capacity. Comprising several maintenance-free single gel batteries.	<input type="checkbox"/>
	2	2.815-091.0	2 -part	24 V	115 Ah	mainte-nance-free		Battery kit with 24 V voltage and 115 Ah (C5) capacity. Comprising several maintenance-free single AGM batteries.	<input type="checkbox"/>
<b>Battery Chargers</b>									
Battery charger	3	6.654-367.0	1 piece(s)	24 V		separate		Battery charger (24 V). Specially developed for charging maintenance-free batteries with a capacity between 70 and 115 Ah.	<input type="checkbox"/>
<b>Accessories for batteries</b>									
Battery mounting kit	4	2.638-104.0	2 -part					Installation kit for installing battery kit in a machine. Incl. brackets and connection cable.	<input type="checkbox"/>
	5	2.638-152.0	3 -part					Installation kit for installing battery kit in a machine. Incl. connection cable and 2 brackets.	<input type="checkbox"/>
Adapter cable	6	4.035-264.0	1 piece(s)					Adapter cable for connecting to the battery charger 6.654-329.0.	<input type="checkbox"/>

■ Included in the scope of supply. □ Available accessories.



# BD 50/70 R CLASSIC \*KAP 1.161-076.0



		Order no.	Quantity	ID	Width	Length	Price	Description	
<b>Other</b>									
Cleaning agent container, complete	1	4.070-006.0	1 piece(s)					Kit consisting of cleaning agent container and Home Base adapter. For connecting Home Base rail.	<input type="checkbox"/>

Included in the scope of supply.
  Available accessories.

# BD 50/70 R CLASSIC \*KAP 1.161-076.0



		Order no.					Price	Description	
<b>Storage</b>									
Basket with bottle insert	1	6.999-290.0						Carrying basket with bottle insert, carrying handle and removable dividers.	<input type="checkbox"/>

Included in the scope of supply.
  Available accessories.